

Plan View

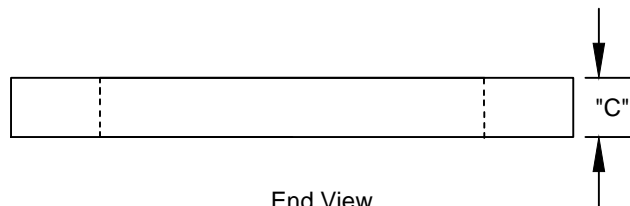

End View

NOT TO SCALE

Specifications

Concrete: Minimum Compressive Strength is 5,000 PSI @ 28 Days.

1" Thick Grade Rings

Model	A"	B"	C"	Approx. Weight
02601	26"	38"	1"	52 lbs.

2" Thick Grade Rings

Model	A"	B"	C"	Approx. Weight
02402	24"	36"	2"	98 lbs.
02602	26"	38"	2"	105 lbs.
03002	30"	40"	2"	95 lbs.
03602	36"	48"	2"	137lbs

3" Thick Grade Rings

Model	A"	B"	C"	Approx. Weight
02603	26"	38"	3"	157 lbs.

4" Thick Grade Rings

Model	A"	B"	C"	Approx. Weight
02404	24"	36"	4"	196 lbs.
02604	26"	38"	4"	209 lbs.

Lake Shore Burial Vault Co., Inc
 12780 W. Lisbon Road
 Brookfield, WI 53005
Phone: 262.781.6262 **Fax:** 262.781.6280
www.lsburialvaults.com

General Notes:

This drawing is the property of Lake Shore Burial Vault Company and shall not be copied or submitted without the consent of this company.

Model: Round Grade Ring

Drawn By: TMQ

Dwg. No.:

Date: 7/21/16